

GUJARAT TECHNOLOGICAL UNIVERSITY**BE - SEMESTER-VIII(OLD) • EXAMINATION – WINTER 2017****Subject Code: 180603****Date:07/11/2017****Subject Name: Professional Practice & Valuation****Time:02.30 PM TO 05.00 PM****Total Marks: 70****Instructions:**

1. Attempt all questions.
2. Make suitable assumptions wherever necessary.
3. Figures to the right indicate full marks.

Q.1 (a) Discuss purposes of estimate. Enlist and explain data required for preparing estimate. **07**

(b) Draft general specifications of high income group building. **07**

Q.2 (a) Refer FIGURE 1 and determine quantity of following item of works. **07**

1. B.B.C.C. (1:4:8) in foundation. 2. Brickwork in super structure in C.M. (1:6).
3. R.C.C. work in Slab, Chhajja and Lintel.

(b) State general principles of deciding unit of measurement of different item of works. State unit of 1. Brick masonry partition wall. 2. Water tank. Explain mode of measurement for plastering work. **07**

OR

(b) Differentiate between 1.Plinth area estimate & Cube rate estimate **07**
2. Revised estimate & supplementary estimate.

Q.3 (a) Prepare detailed estimate for earthwork for portion of a road from the following data. **07**

Distance in m	0	100	200	300	400	500	600
RL of ground	115.50	115.75	116.25	116.20	117.10	117.85	119.00

RL of formation level is 116.00 upward gradient 1 in 200 up to 600m. **07**
Formation width of road=10.00m. Side slope in banking 2:1.

(b) How specification is useful to estimator, site engineer, contractor and arbitrator.

OR

Q.3 (a) Draft detailed specifications for **07**
1. Brick partition wall C.M. (1:4) 2. R.C.C. (1:1.5:3) slab and beam floor.

(b) Draft general specifications for flexible road. **07**

Q.4 (a) Define Rate Analysis. What are the purposes of it? Also state the factors affecting rate of an item. **07**

(b) Carry out rate analysis for 12mm thick smooth plastering work in cement mortar 1:4 over brick work with cement slurry finish. Assume suitable rates for material and labors. **07**

OR

Q.4 (a) Prepare schedule of materials for using following data. **07**

- 1.P.C.C.(1:1.5:3)= 27.00 cum 2. First class brick work C.M. (1:6) = 210 cum.
3. 12mm sooth plaster C.M. (1:6) = 950 sqm.

(b) Explain leasehold property. 07

A landlord receives rent of Rs. 5000/- per month from his flat by tenant for last many years. Property taxes = 3000/- per annum. N.A. tax = Rs. 500/-per annum. Repair and maintenance 5% of gross rent. Insurance premium=1% of gross rent. Rate of return = 7%. Determine the value of the property.

Q.5 (a) State purpose of Measurement Book. Discuss points to be considered in recording the Measurement Book. 07

(b) Explain item rate contract. State advantages and disadvantages of it. 07

OR

Q.5 (a) What is contract document? Enlist and explain various contract documents. 07

(b) Draft typical tender notice for the construction of school building worth Rs 5000000/- at Palanpur uday education trust.. 07

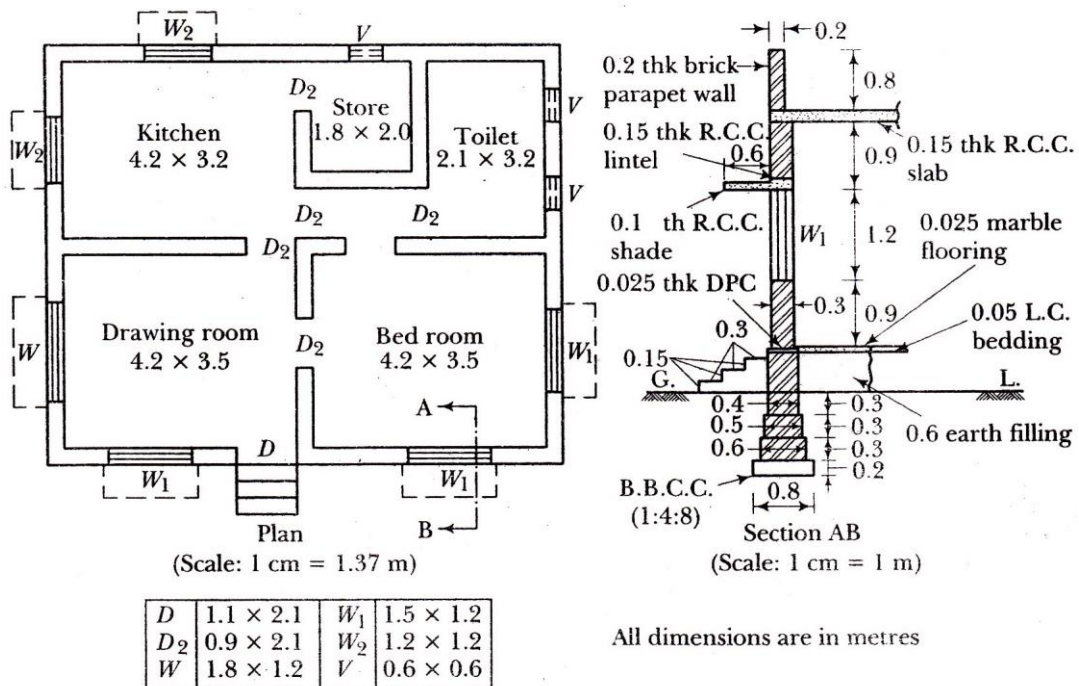

FIGURE 1